



HIGH BREAK VOLTAGE (800V、1000V) PLASTIC CASE CIRCUIT BREAKER



THE PRODUCT APPLICATION

CLBM3 series plastic case circuit breaker (hereinafter referred to as circuit breaker) is one of the new circuit breakers developed by our company with international advanced design and manufacturing technology. Its rated insulation voltage is 1000V, which is suitable for the circuit with ac 50Hz, rated working voltage of 1000V and below, rated working current of 630A, for infrequent conversion and infrequent starting of the motor. Circuit breaker with overload, short circuit, protection function, can protect the line, power equipment from damage.

The circuit breaker has the characteristics of small volume, high breaking, short arc (some specifications zero arc), anti-vibration and so on.

The circuit breaker can be installed vertically (i.e. vertically) or horizontally (i.e. horizontally).

This circuit breaker can not be reversed into the line, that is, only 1, 3, 5 can be connected to the power line, 2, 4, 6 to the load line.

This circuit breaker is suitable for isolation (but different from isolation switch).

CONFORM TO THE STANDARD

IEC 60947-1 and GB/T 14048.1 low-voltage switchgear and control equipment - part 1 general rules

IEC 60947-2 and GB/T 14048.2 low-voltage switchgear and control equipment - part 2 circuit breakers

IEC 60947-4-1 and GB/T 14048.4 low-voltage switchgear and control equipment - part 4 contactors and motor starters

IEC 60947-5-1 and GB/T 14048.5 low-voltage switchgear and control equipment - part 5 electromechanical control circuit appliances

CONDITIONS OF USE

Altitude 2000m and below;

Ambient medium temperature is not higher than +40°C and not lower than -5°C ;

Ability to withstand the influence of moist air;

Ability to withstand the impact of salt fog, oil fog;

Ability to withstand the impact of mold;

The maximum inclination was $\pm 22.5^\circ$.

Where there is no explosion hazard in the medium and the medium is not enough to corrode the metal and destroy the insulation of the gas and conductive dust;

Where there is no rain or snow

CLBM3 - 250 HU P 3 3 00 TH

CLBM3	Enterprise product code
250	Bracket grade current optional code: 250、400、630
HU	High voltage class
P	Operation mode optional code: No code: direct operation Z turn handle to operate P electric operation
3	Number of poles: 3 tripoles
3	Optional code of tripper mode: Only 2.electromagnetic trip 3. Thermal action + electromagnetic trip
00	Internal attachment code
TH	Place and environment code:No code normal environment TH tropical type

Model		CLBM3-250HU		CLBM3-400HU		CLBM3-630HU	
Rated current	A	63、80、100、125、140、160、180、200、225、250		225、250、315、350、400		400、500、630	
The number of		3					
Rated working voltage Ue AC 50-60Hz	V	800	1000	800	1000	800	1000
Rated insulation voltage Ui	V	1000					
Rated shock withstand voltage Uimp	kV	8					
Power frequency withstands voltage (1min)	V	3500					
Rated ultimate short-circuit breaking capacity Icu	kA	20	10	20	10	20	10
Rated operating short circuit breaking capacity Ics	kA	15	8	15	8	15	8
Mechanical life	time	10000			6000		
Electrical life	AC800V	time					
	AC 1000V	time					
Basic size	mm	107X165X103		150X257X106.5		182X270X110	
Arcing distance	mm	≥ 100					
Reference ambient temperature	°C	40					
Isolation function		●					
Instantaneous trip		5Inor10In					

Note: terminals 1, 3 and 5 of circuit breakers are connected to the transformer side, while terminals 2, 4 and 6 accept the current side

BASIC DIMENSIONS

EXTERNAL DIMENSIONS AND MOUNTING DIMENSIONS

CLBM3-250HU

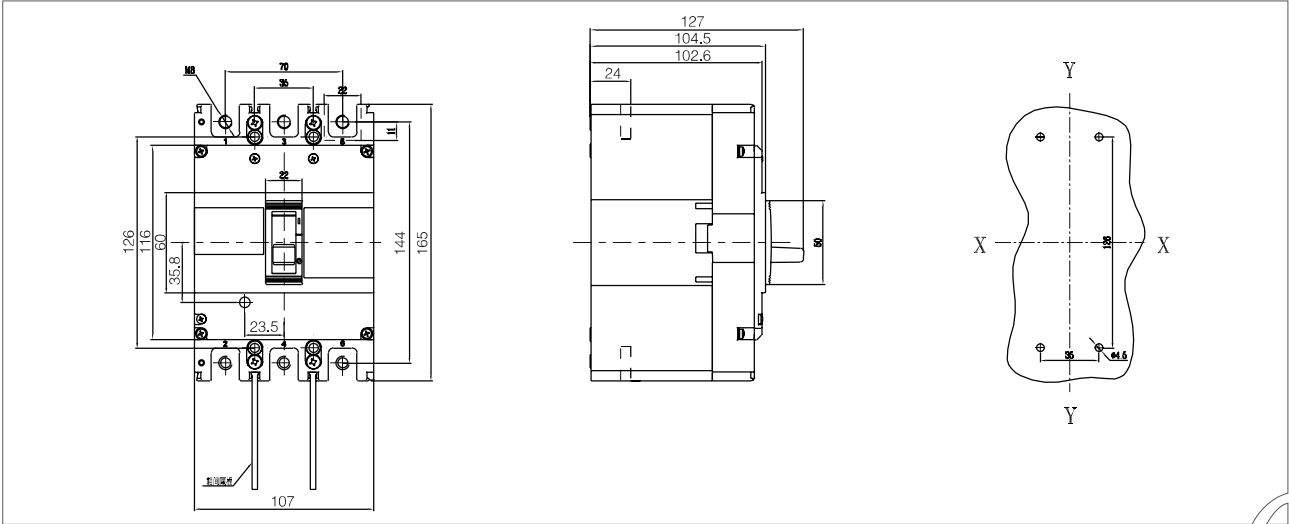

CLBM3-400HU

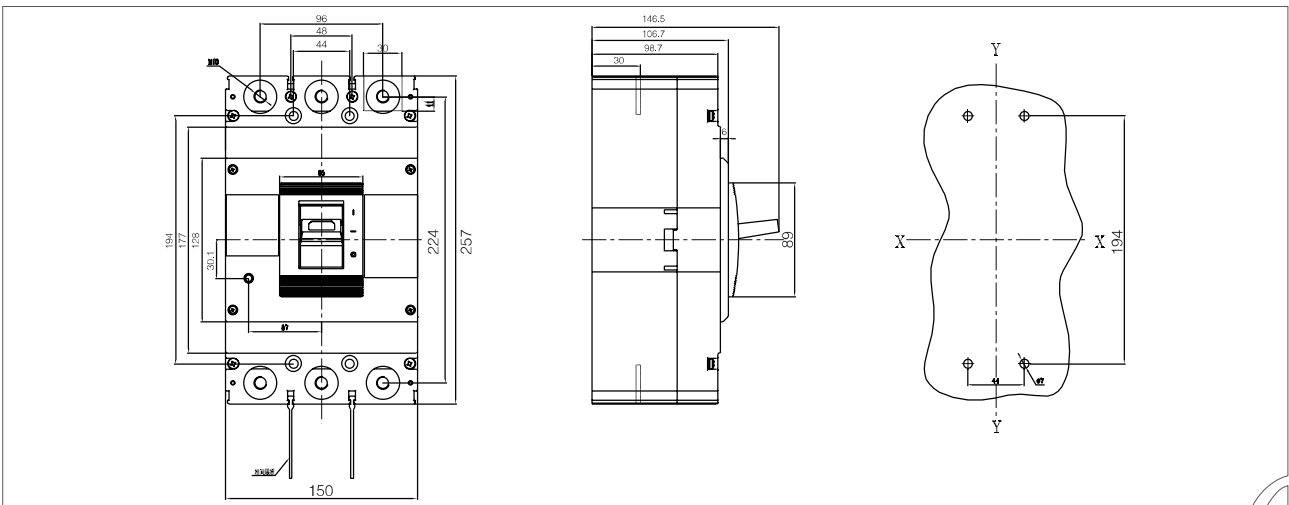

CLBM3-630HU

